

HOWELL & HOWELL  
RECORD BOOK 1051, PAGE 2369  
MAP 49, PARCEL 3.00

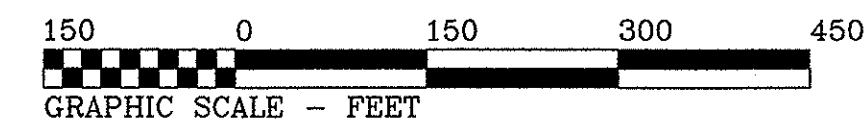

LOCATION SKETCH n.t.s.

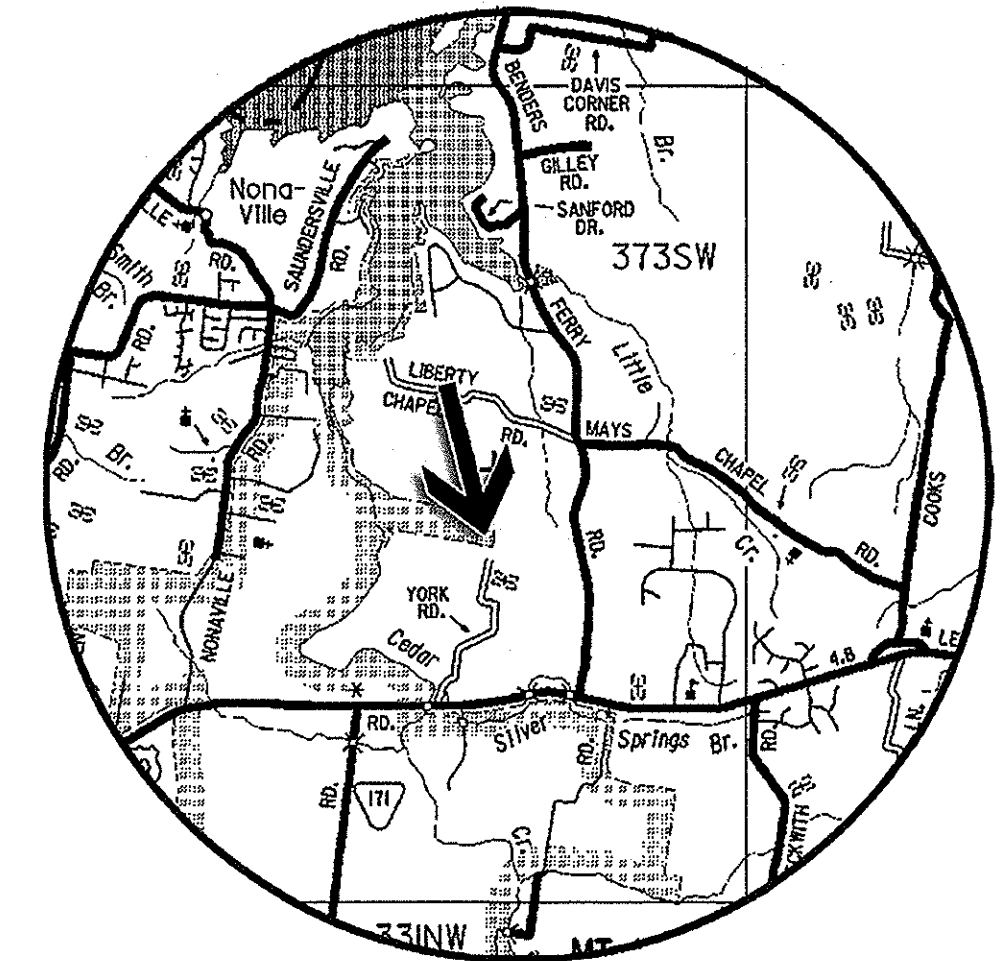

RICHARD VAN KLUYVE  
RECORD BOOK 1853, PAGE 1366  
MAP 49, PARCEL 8.02

NICHOLAS R. CUNNINGHAM  
RECORD BOOK 1398, PAGE 1195  
MAP 49, PARCEL 68.05

M & M FARMS, LLC.  
RECORD BOOK 1381, PAGE 893  
MAP 49, PARCEL 69.08

CORPS OF ENGINEERS  
(OLD HICKORY LAKE)

BOUNDARY SURVEY FOR

# FRANKIE L. MASSA

LOCATED IN THE 1ST CIVIL DISTRICT OF WILSON COUNTY, TENNESSEE

SCALE : 1" = 150'  
DATE : JULY 17, 2019  
SIZE : 77.76 AC.+  
DEED : R. B. 1328, PG. 1149, R.O.W.C.T.  
MAP : MAP 49, PAR. 71.01, T.A.O.W.C.T.

CITY OF MT. JULIET  
DEED BOOK 424, PAGE 869  
MAP 49, PARCEL 71.00

CALL TABLE

Course	Bearing	Distance
L1	N 57°37'52" W	65.30'
L2	S 09°08'18" W	86.75'
L3	S 08°02'07" W	118.73'
L4	S 01°00'22" W	12.21'
L5	S 31°05'55" W	36.20'
L6	S 48°52'21" E	107.32'

SURVEYOR'S CERTIFICATE:  
I HEREBY CERTIFY THAT THIS IS A CATEGORY 1 SURVEY, AND THAT THE RATIO OF PRECISION OF THE UNADJUSTED SURVEY IS AT LEAST 1 : 10,000 AS SHOWN HEREON.

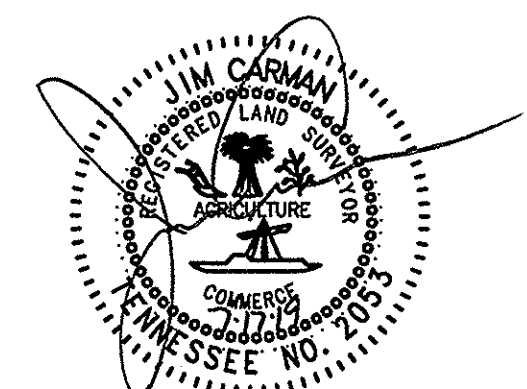

CARMAN SURVEYING  
120 WINDLE CANY ROAD  
HARTSVILLE, TENNESSEE  
PHONE: (615) 574-2544

# PLAT CONTAINS 77.76 ACRES+-

YORK ROAD